

# ASSEMBLY INSTRUCTIONS

MODEL: B9100-Q-HBFB, B9100-K-HBFB, B9100-NK-HBFB, B9100-NK/QK-RAIL

Thank you for purchasing this quality product. Be sure to check all packing material carefully for small parts which may have come loose inside the carton during shipment. Identify and count all parts and compare with hardware list as below:

PART LIST		
[BOX 1] BOX OF HEADBOARD		
ITEM DRAWING	DESCRIPTION	QTY
<b>A</b>	HEAD BOARD	1

[BOX 2] BOX OF FOOTBOARD		
ITEM DRAWING	DESCRIPTION	QTY
<b>B</b>	FOOT BOARD	1
<b>C</b>	WOODEN SLAT	13
<b>D</b>	CENTER SLAT	1
<b>E</b>	SLATS SUPPORT	4

[BOX 3] BOX OF SIDE RAILS		
ITEM DRAWING	DESCRIPTION	QTY
<b>F</b>	SIDE RAILS	2

[BOX 2] BOX OF FOOTBOARD HARDWARE LIST			
ITEM DRAWING	DESCRIPTION	DIMENSION	QTY
<b>G</b>	C.S.K SCREW (M4)	4 x 32MM	9

Screw Driver is not included  

## STEP 1

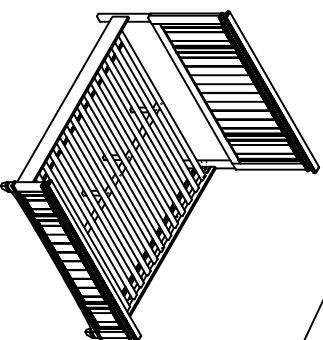
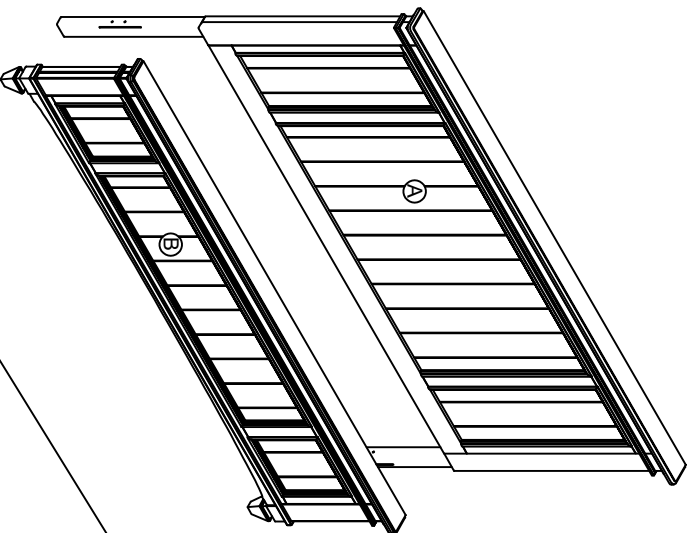

**COMPLETED ASSEMBLY**

NOTE: MUST TIGHTEN SCREW PERIODICALLY WITH USE. SCREWS WILL BECOME LOOSE. CHECK TIGHT OF ALL SCREWS EVERY 6-8 WEEKS.

CLEANING INSTRUCTION

After assembled, clean & polish the complete parts if necessary with soft cloth and industrial recognized furniture polish.

## STEP 3

STEP 3 : Fix the Support Leg (E) into the Slat Support (D) as show and adjust it to the height required.

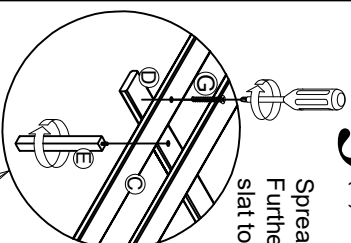

Spread out all the Slat (C) on the Center Slat (D). Further secure 32mm screws (G) to middle pre-drilled slat to the Center Slat (D).

## STEP 4

STEP 4 : Finally, secure the Wooden Slat in place with the 32mm screws (G) with screw driver (\*not include)

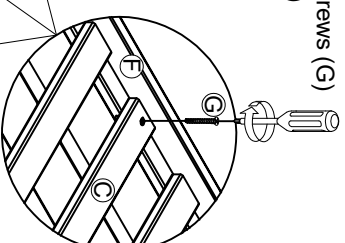

## STEP 2

STEP 2 : Fix both side rails to the Headboard and Footboard as below

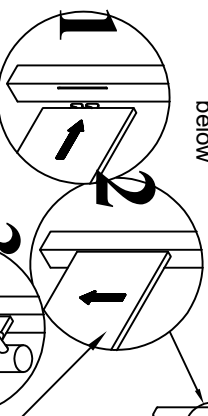

Press laterally into the groove and drop down.

**Important !!**

LEVEL THE SIDE RAIL BY COVERING WITH A SOFT CLOTH AND TAPPING WITH A HAMMER.

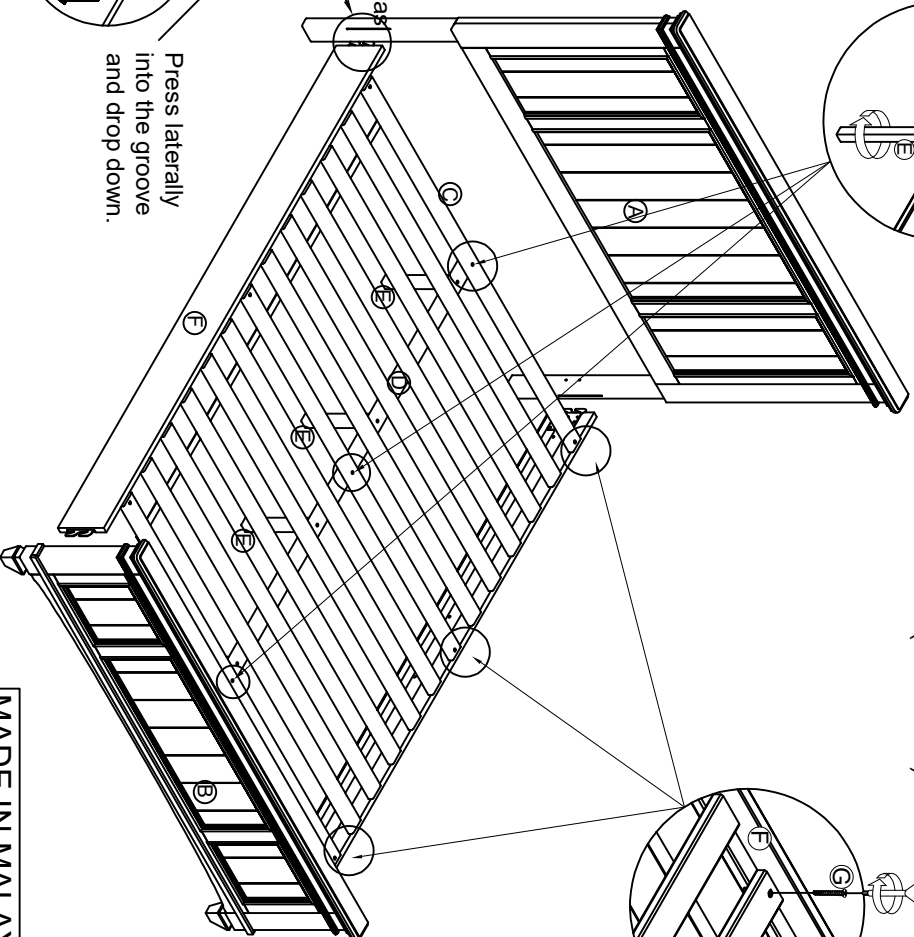

THE HARDWARE IS LOCATED IN THE PACKING ITEMS

MADE IN MALAYSIA